

Notes

1. This drawing has been prepared in accordance with the scope of RPS's appointment with its client and is subject to the terms and conditions of that appointment. RPS accepts no liability for any use of this document other than by its client and only for the purposes for which it was prepared and provided.
2. If received electronically it is the recipient's responsibility to print to correct scale. Only written dimensions should be used.
3. This drawing should be read in conjunction with all other relevant drawings and specifications.

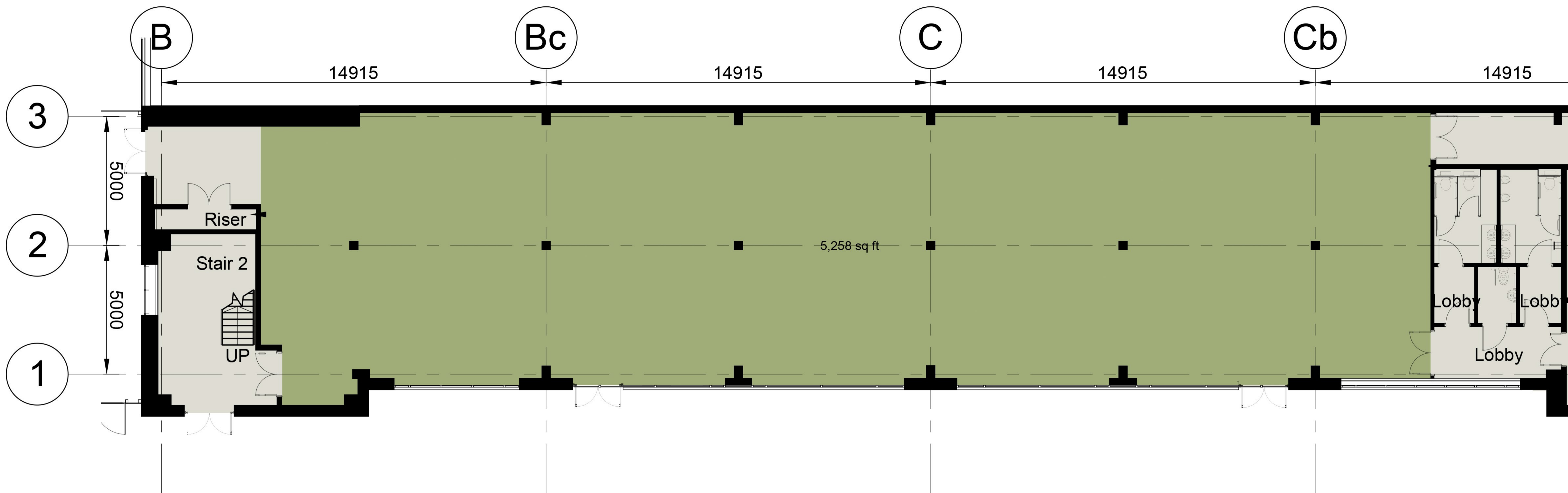

Ground Floor Potential Office Layout
Total Available Space - 5,258 sq ft

Rev	Description	By	Ckd	Date
-----	-------------	----	-----	------



Sherwood House, Sherwood Avenue,
Newark, Nottinghamshire, NG24 1QQ
T: 01636 605 700 E: rpsnewark@rpsgroup.com

Client



Project DP World London Gateway
Logistics Centre

Title Phase 2 Offices
Ground Floor
Option 03

Status	Scale	Date Created
Preliminary	1:75 @A1	11/06/18
Project Leader	Drawn By	Checked by
KRP	DEC	MJH

Document Number	Revision	Subsidiary
NK018210-SK027	-	S0

Project Number	Originator	Zone	Level	Type	Risk	Issuing Number
----------------	------------	------	-------	------	------	----------------

